

The Dovey Shok Blok™

For Steel to Steel Applications

Please specify your machine size when ordering

Information and Quote on **Shok Blok™**

The advantages are impressive.

- Operation is so much quieter you wonder if cutting is taking place.
- The cross blade is held completely captive against the male slot blade thus ensuring the tab is always cut. Present steel tab cutting suffers from the blade drifting away. Shok Blok removes the damaging impact of poorly adjusted blades and improves the life of anvil and blades.
- Faster speeds result since no tab hang-up is present. Blade is only changed when going from E flute to A. Otherwise same blade is used from single wall to double wall.
- The cutting action is one of helical “roll over the anvil surface” and opposed to the guillotine “chop” type impact cutting machines.

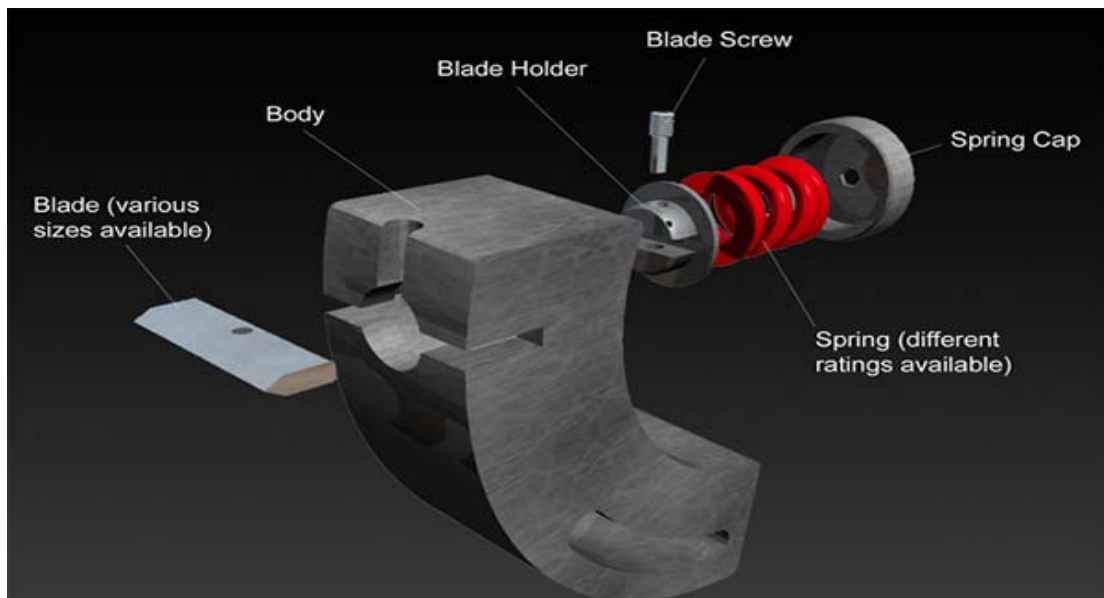

Your Dovey Area Manager is

Gary Lovelace & Associates

Gary Lovelace (850) 206-3823 • Drew Lovelace (850) 723-2963

gary@corrugatedonline.net

SHOK BLOK™ INSTALLATION

INSTRUCTIONS

- 1) Remove original stitch lap blocks from the slotter head.
- 2) Open shafts out to maximum adjustment.
- 3) Fit leading and trailing Shok-Bloks™ in same position as original blocks.
- 4) Rotate shaft round **BY HAND** until cutting blade is directly over the anvil.
- 5) Adjust shafts together until contact with blade is made. Stop when the blade starts to compress (up to 1/32). Ensure the pressure setting is same as used for board grade. Change blade for higher or lower if necessary.
- 6) Rotate the slotter head **BY HAND** to check correct operation.
- 7) Run machine and adjust shaft pressure +/- 3/16" if necessary to obtain perfect cut.
- 8) **IMPORTANT NOTE**: Never exceed 3/16" compression of the blade.
- 9) Replace worn blades and springs as necessary.
- 10) To replace blade, remove M4 cap screw with T key provided. Screw must be tight before running. Note: blade must float freely.
- 11) To replace spring, remove base plug with T wrench supplied. Note: **This plug does not adjust the spring pressure or blade height by tightening.** To increase spring pressure, change to brown springs. Change blade for higher type if necessary.
- 12) It is recommended that a spares kit be purchased with the above equipment in order to eliminate downtime.

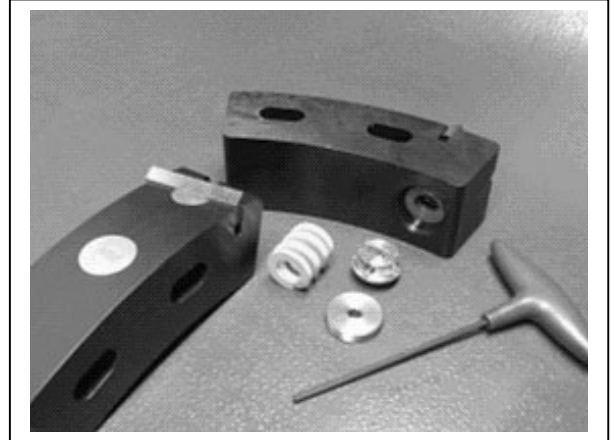

DOVEY CORP.
 3220 W. 25th STREET
 ANDERSON, IN 46018
 PH. 765-649-2576
 800-457-2576
 FAX 765-649-1934
 800-424-2559
 E-MAIL DOVEY@DOVEYCO.COM

UPPER SLOTTER HEAD
 SPEC. SHEET

CHECK ONE
 3/8 "T" BOLT
 1/2 "T" BOLT

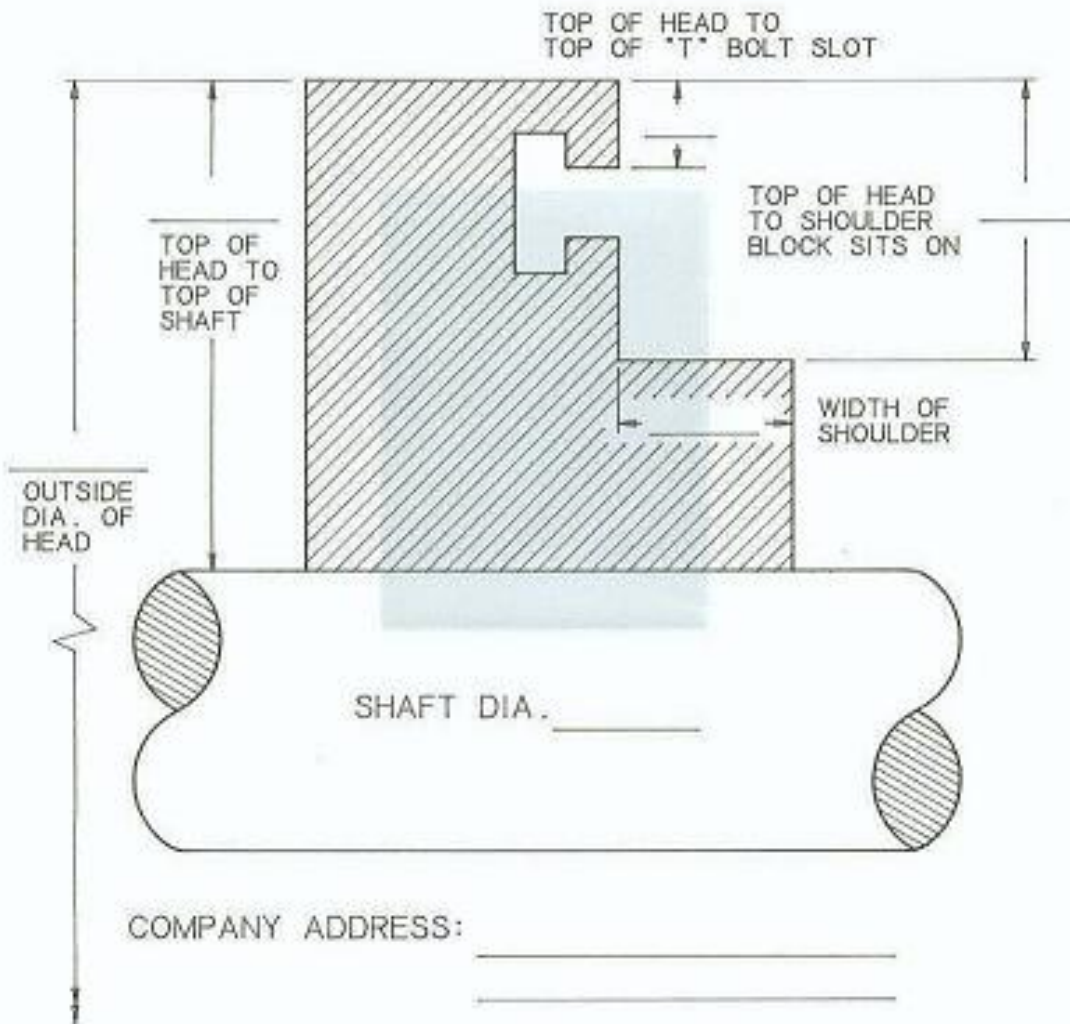

COMPANY ADDRESS: _____

PRESS SIZE: _____
 CONTACT PERSON: _____
 DATE: _____

EXTEND THE USE OF YOUR TAB KNIVES WITH SHOK BLOK™

13) SPRING LOADED KNIFE ABSORBS SHOCK AND REDUCES OPERATIVE NOISE DRASTICALLY.



14) REPLACES PRESENT TAB BLOCK WITHOUT ANY MODIFICATION TO STD. STITCH LAP SLOTTED HEAD.

15) THE CUTTING ACTION IS ONE OF HELIXICAL "ROLL OVER THE ANVIL SURFACE" AND ELIMINATES THE GUILLOTINE "CHOP" TYPE OF IMPACT TAB CUTTING. TAB CUTTING IS ALMOST NOISELESS.

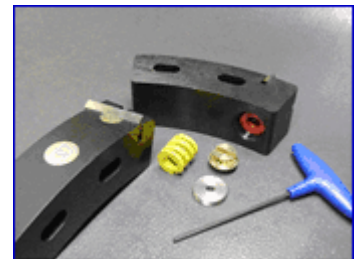

16) FASTER SPEEDS RESULT SINCE TAB HANGUP IS ELIMINATED.

17) THE SHOK BLOK HOLDS THE CROSS KNIFE COMPLETELY CAPTIVE AGAINST THE MALE SLOTTED KNIFE AND ELIMINATES THE PROBLEM OF KNIFE DRIFT ASSOCIATED WITH SOLID TAB KNIFE HOLDERS.

18) KNIFE AND ANVIL LIFE IS INCREASED AND WORN KNIVES ARE QUICKLY REPLACED. COST OF SOFT ANVIL COVERS IS ELIMINATED.

19) SET UP TIME IS REDUCED BECAUSE KNIFE SET REQUIRES ONLY THAT KNIFE TOUCH STEEL ANVIL +/- 1/32 PRESSURE.

DOVEY CORPORATION,
3220 W. 25th Street,
ANDERSON, IN 46018
800-457-2576

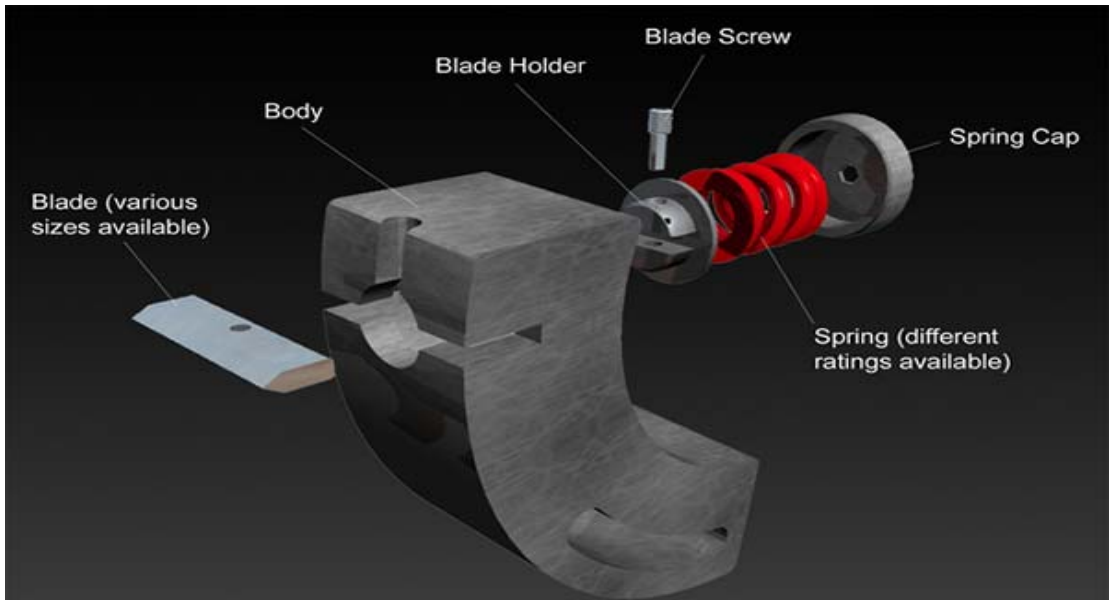

SHOK BLOK™ ANVILS

